

Section

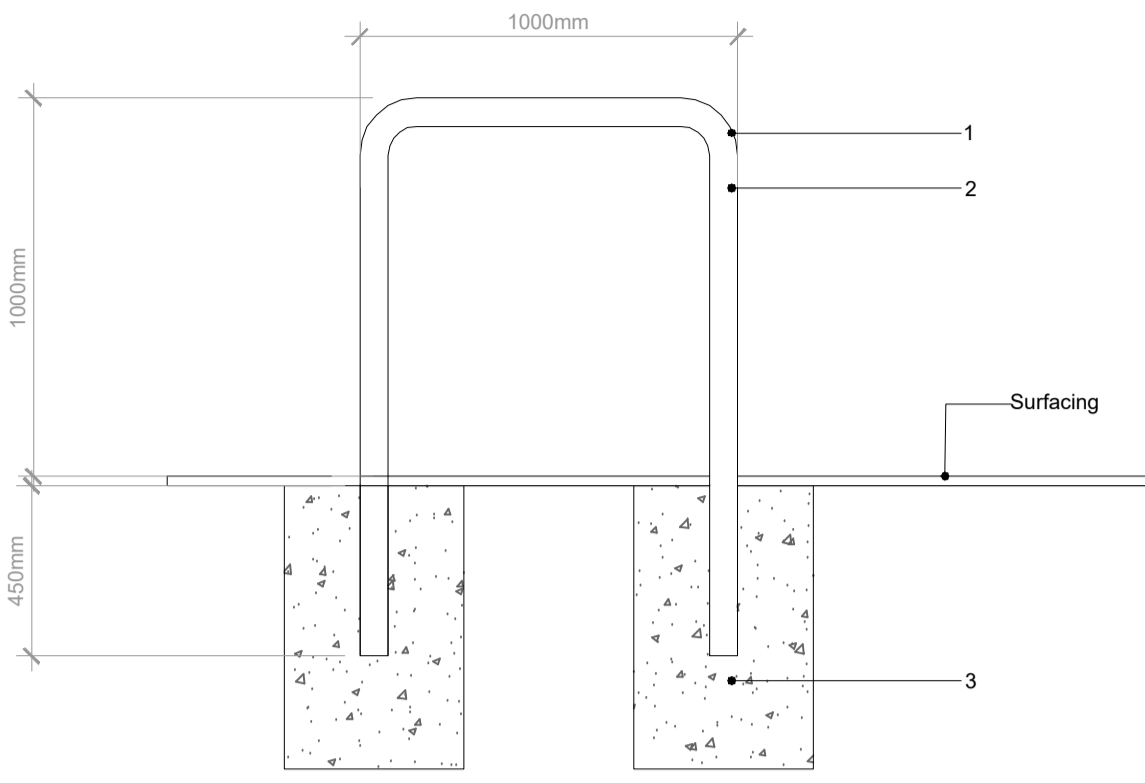

- Notes:
- 150mm internal radius
 - 75mm diameter mild steel/Stainless Steel tube, finish TBD.
 - Concrete Foundation to engineering specification

Plan

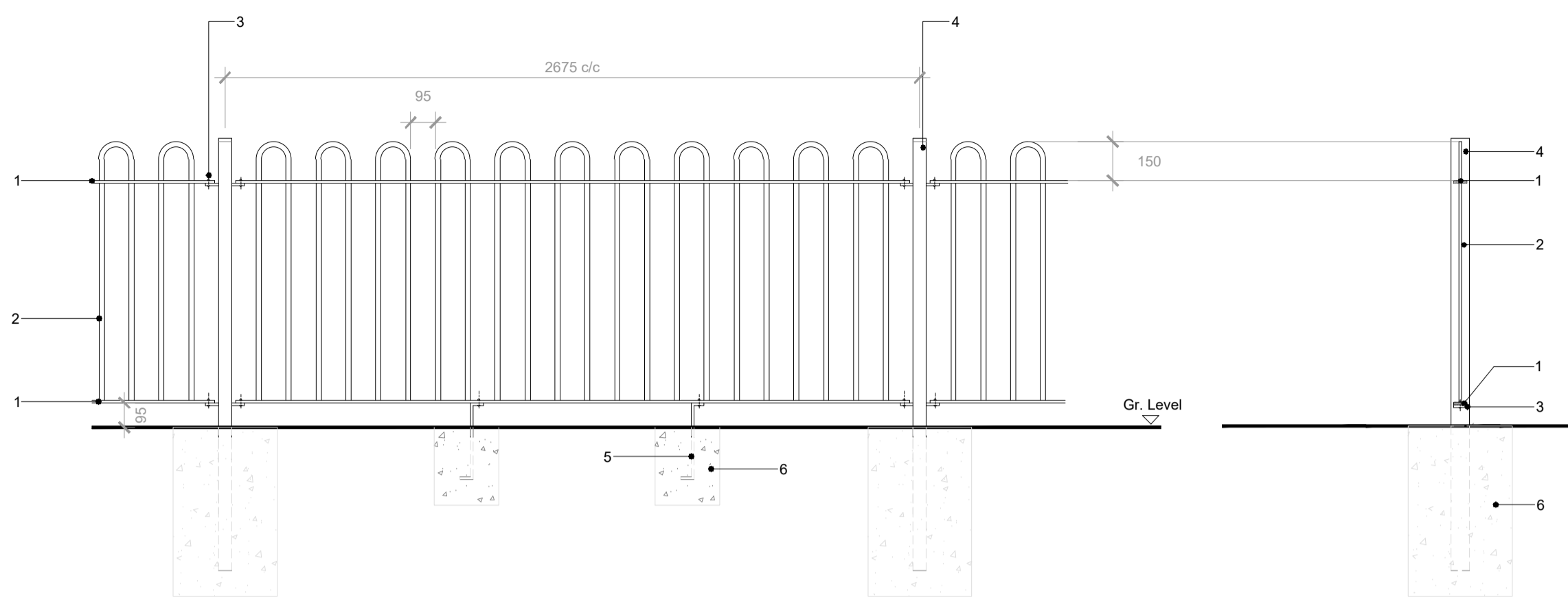
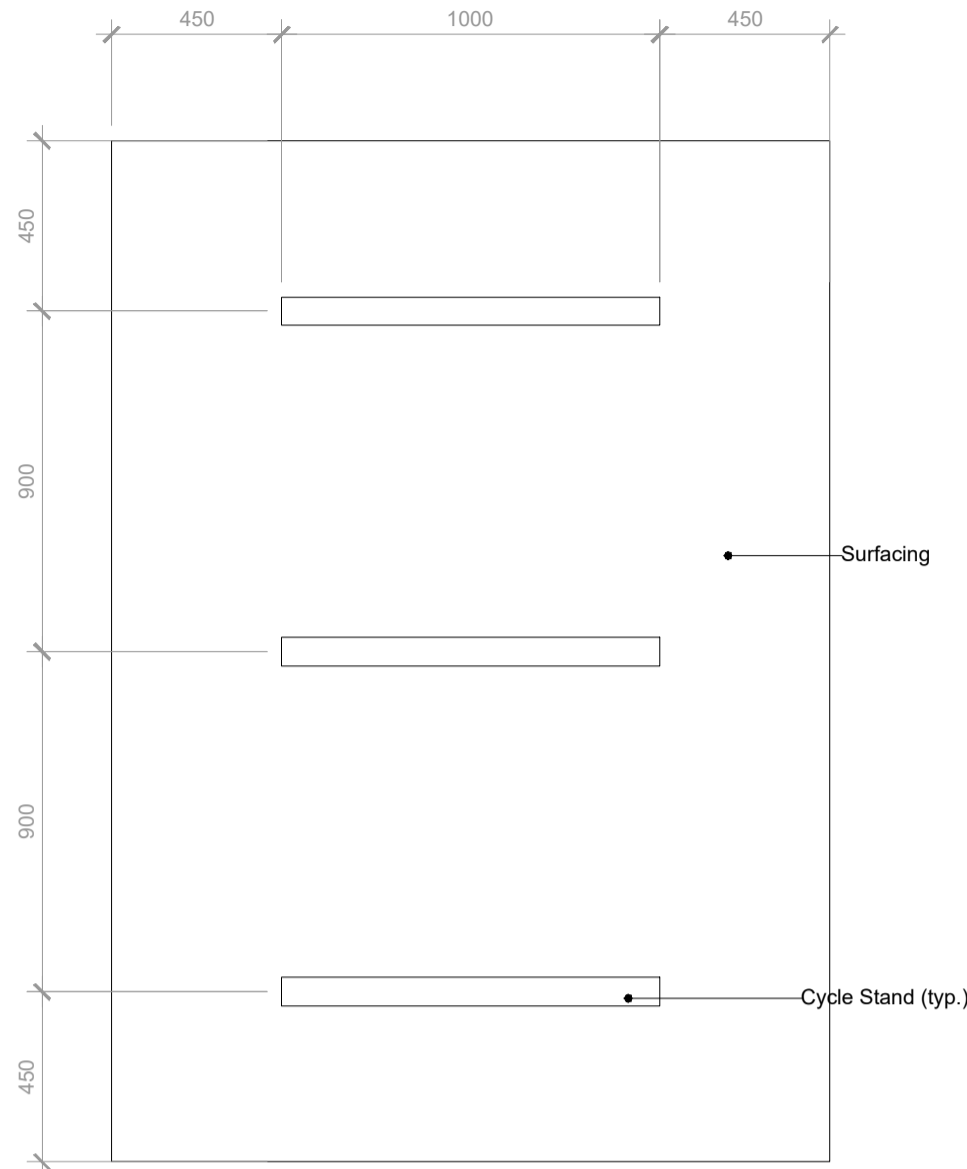

- Notes:
- Horizontals to be 50x10mm solid rectangular sections. The top horizontal is to be no less than 150mm from the top of the railing and the bottom horizontal is to be no less than 75mm and no greater than 95mm from ground level.
 - Verticals are to be 20mm dia. solid round sections and to be set no greater or less than 95mm apart.
 - Fishplates are to be 50x50x10mm welded to RHS and bolted to panels.
 - RHS (Rolled Hollow Section) posts are to be 50x50x3mm sections and sealed with a cap at the top. Posts are to be embedded 550mm below ground level.
 - Supports are to be 'Z' shaped, with a 50mm bend, bolted to panels and embedded 200mm below ground level.
 - Concrete footings are to be C10 type concrete as BS 5328-1:1997. A minimum clearance of 100mm is to be provided around the posts or supports.

All railings and RHS posts are to be of mild steel as to BS 4-1, hot dipped galvanised as to BS EN ISO 1461 & with a polyester power coated black finish as to BS 6497. All fixings are to be of M10 bolts and permacone, anti-vandal proof.

All railings are to be in accordance with BS 1722-9:2000.

Exact lengths of posts and supports may have to be adjusted due to variations in ground levels on site.

Pedestrian Gate 1.2m wide to match also to be supplied. Gate to be fitted with self-closing mechanism.

Bench Seat Wall Typical Detail
Scale 1:20
D.02
03

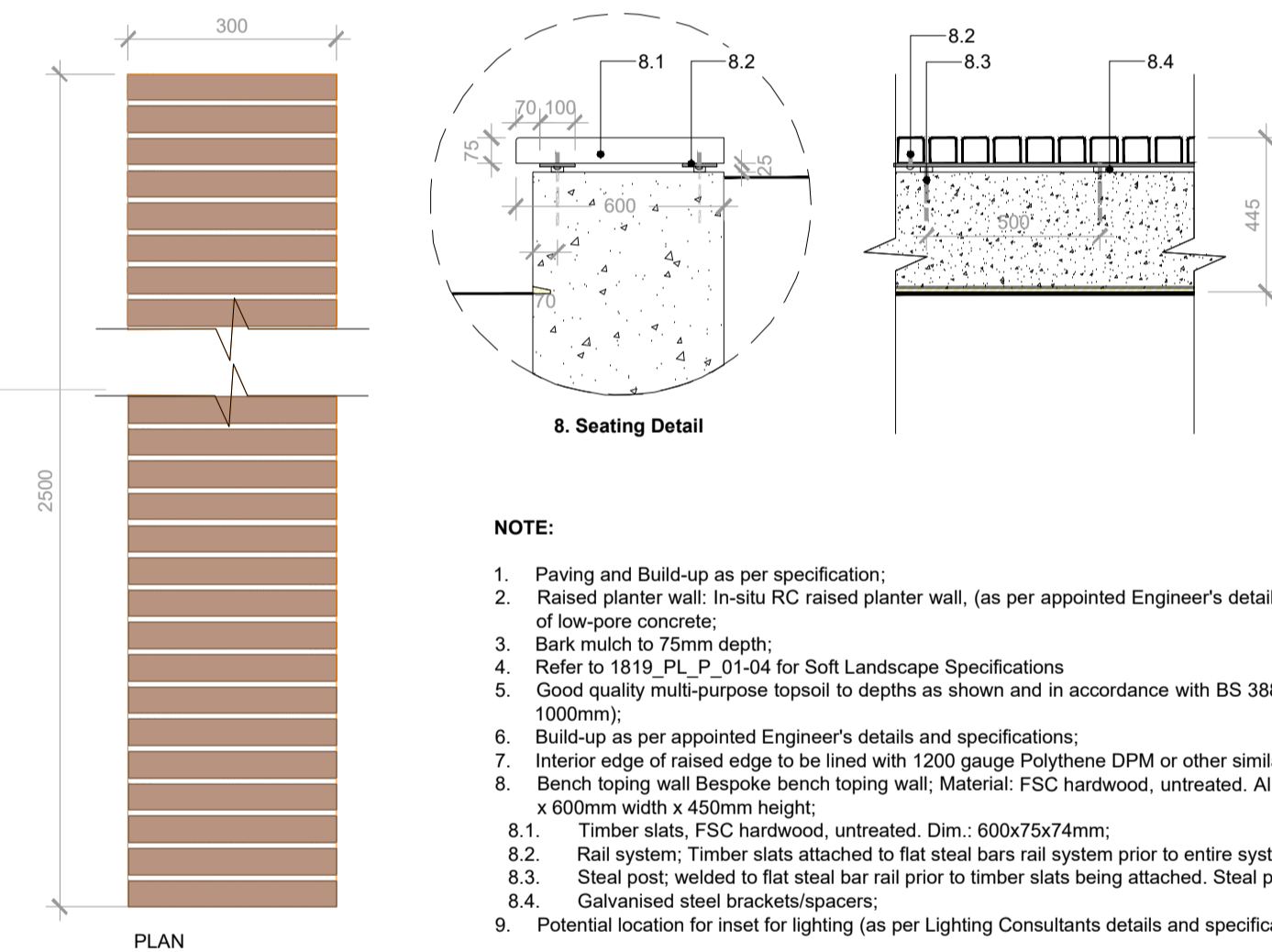

NOTE:

- Paving and Build-up as per specification;
- Raised planter wall: In-situ RC raised planter wall, (as per appointed Engineer's details and specifications) 50% GGBS; 45N C35/45 (exposure class XS1) and Concrete admixture for the production of low-pore concrete;
- Bark mulch to 75mm depth;
- Refer to 1819_PL_P_01-04 for Soft Landscape Specifications
- Good quality multi-purpose topsoil to depths as shown and in accordance with BS 3882 (amenity grass min. 150mm, perennials and ornamental grasses min.300mm, shrubs min.450mm, trees min. 1000mm);
- Build-up as per appointed Engineer's details and specifications;
- Interior edge of raised edge to be lined with 1200 gauge Polythene DPM or other similar and approved waterproof membrane;
- Bench toping wall Bespoke bench toping wall, Material: FSC hardwood, untreated. All metalwork to be hot dipped galvanised steel (as per supplier's recommendations); dim.: 12,000mm total length x 600mm width x 450mm height;
- Timber slats, FSC hardwood, untreated, Dim.: 600x75x74mm;
- Rail system: Timber slats attached to flat steel bars rail system prior to entire system being affixed to wall
- Steel post, welded to flat steel bar rail prior to timber slats being attached. Steel post to be affixed/motered to wall in pre-drill holes in finished wall
- Galvanised steel brackets/spacers;
- Potential location for inset for lighting (as per Lighting Consultants details and specifications).

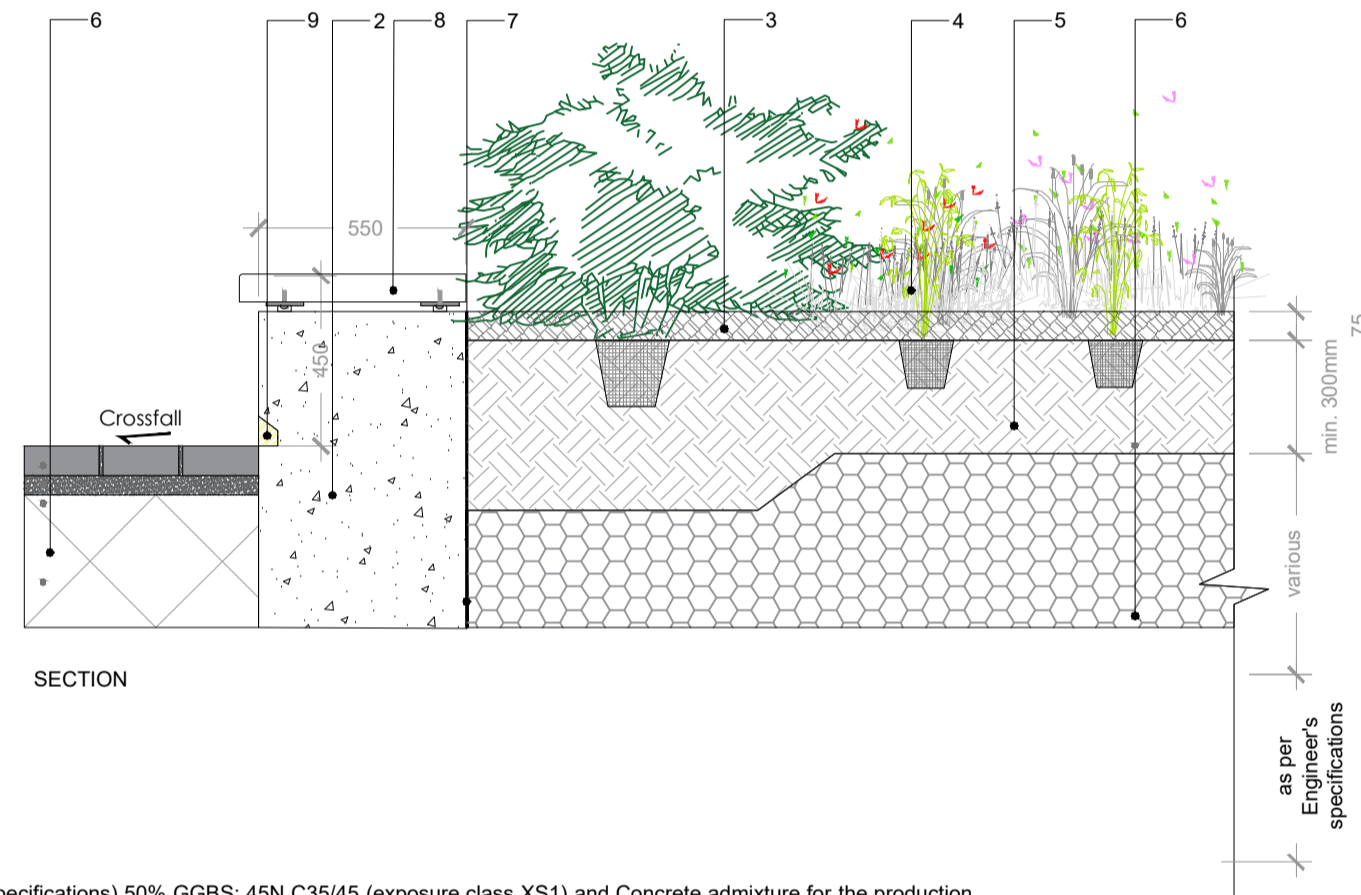

Handrail to Steps
Scale 1:20
D.05
03

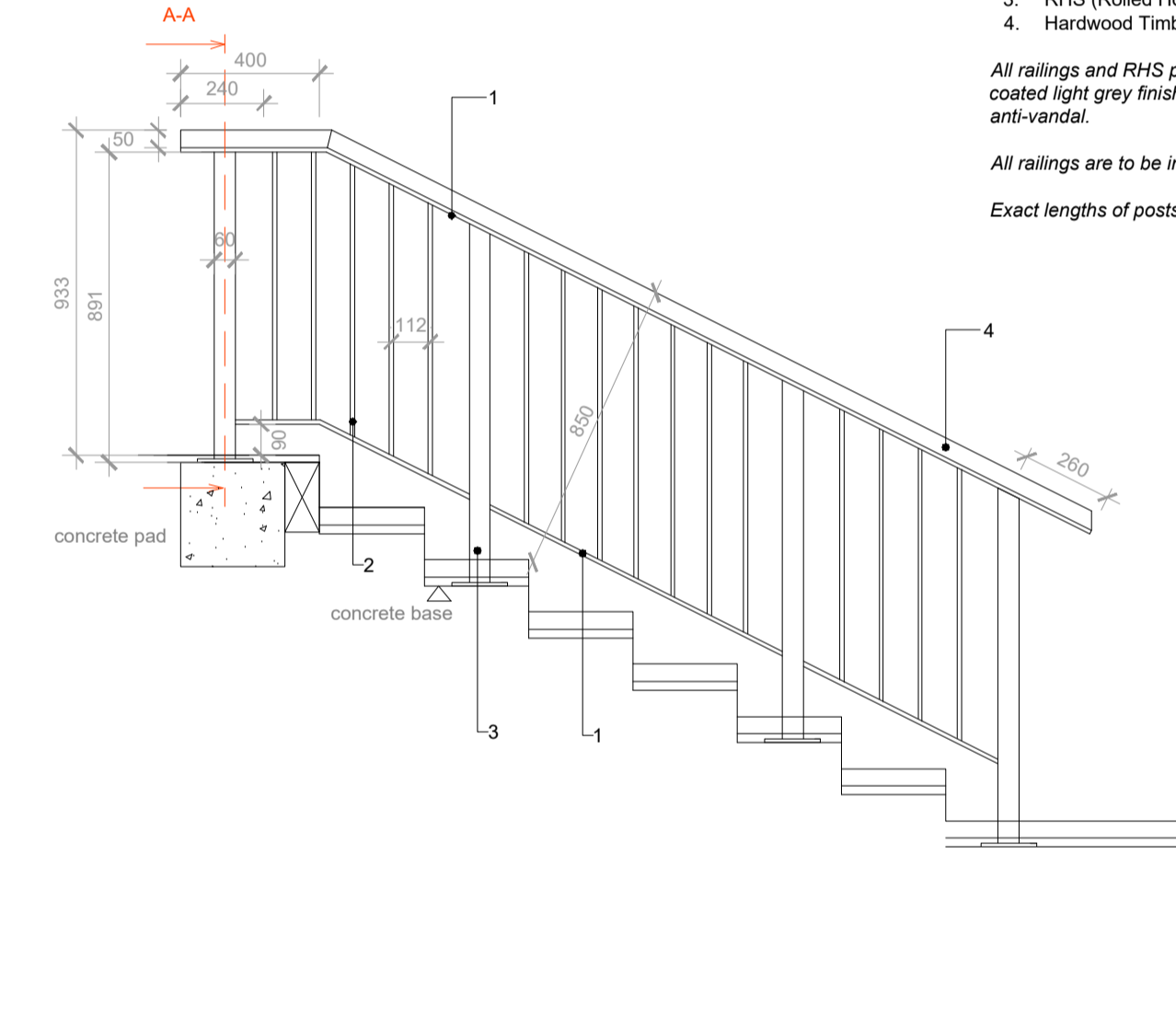

- Notes:
- Horizontals to be 50x10mm solid rectangular sections. The top horizontal is to be no less than 150mm from the top of the railing and the bottom horizontal is to be no less than 75mm and no greater than 95mm from the pitch line of the steps.
 - Verticals are to be 12mm dia. solid round sections and to be set at centres shown.
 - RHS (Rolled Hollow Section) posts are to be 60x60x3mm sections. Posts are to be welded to base plate 220x160x10mm.
 - Hardwood Timber handrail, rounded profile as per section A-A; sanded and polished finish

All railings and RHS posts are to be of mild steel to BS 4-1, hot dipped galvanised to BS EN ISO 1461 & with a polyester power coated light grey finish (RAL 7044 - or similar by approval) to BS 6497. All fixings are to be of M10 bolts and permacone, anti-vandal.

All railings are to be in accordance with BS 1722-9:2000.

Exact lengths of posts and supports are to be checked on site.

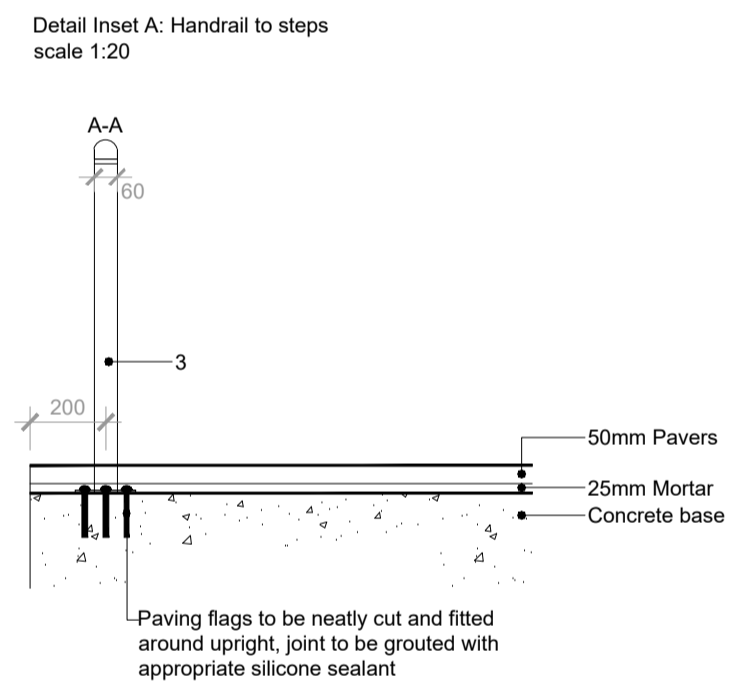
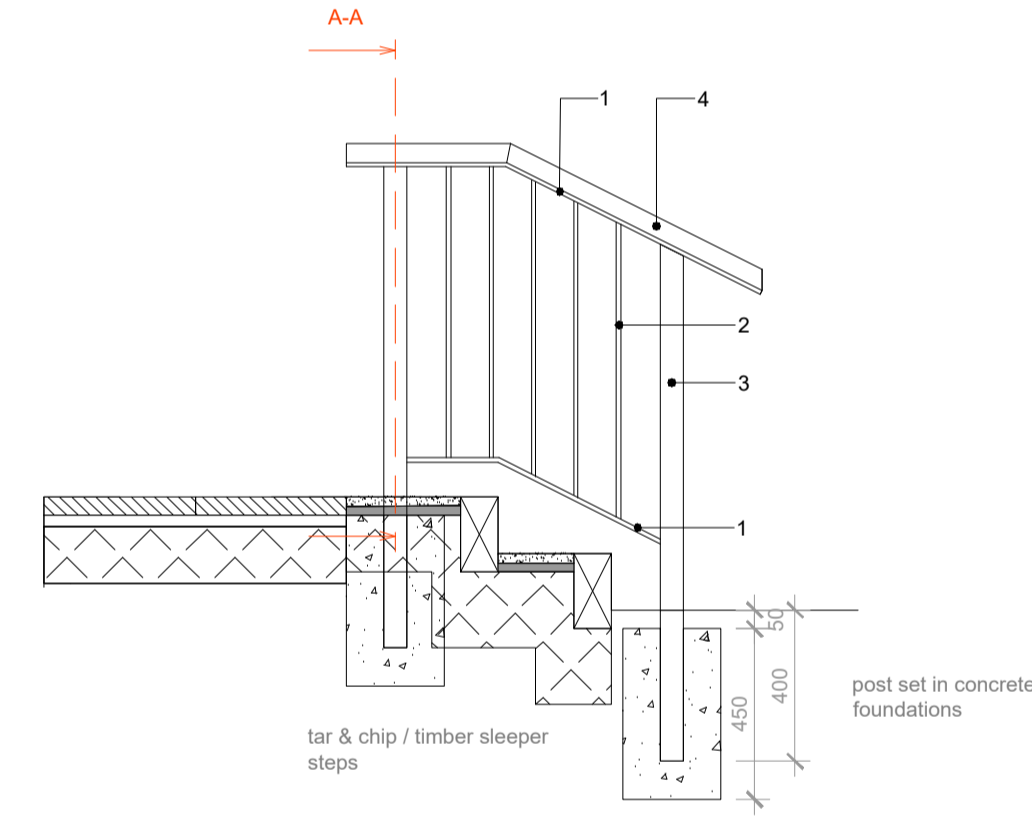

Free Standing Bench Type 1-2
Typical Detail
Scale 1:20
D.03
03

- Notes:
- Paving and Build-up as per specification.
 - Cast in situ 35N20 concrete foundation under proposed surface treatment (as per Engineer's details and specifications);
 - Seating: Powder coated stainless steel & recycled composite timber bench. Supplier: Hartecast (&/or similar proposed), Product: HC2033S Seat (with backrest/arm rest) and HC2033B Bench (without backrest), Dim.: 1800mm, H450mm, D455mm;
 - Timber slats Dim.: 70x40mm and 90x40mm;
 - Surface mounted- the supports are fitted with a stainless steel base plate with 2 fixing points.
 - Block A&B courtyard: HC2033B Bench
 - Block C&D courtyard: HC2033B and HC2033S 50/50 mixed

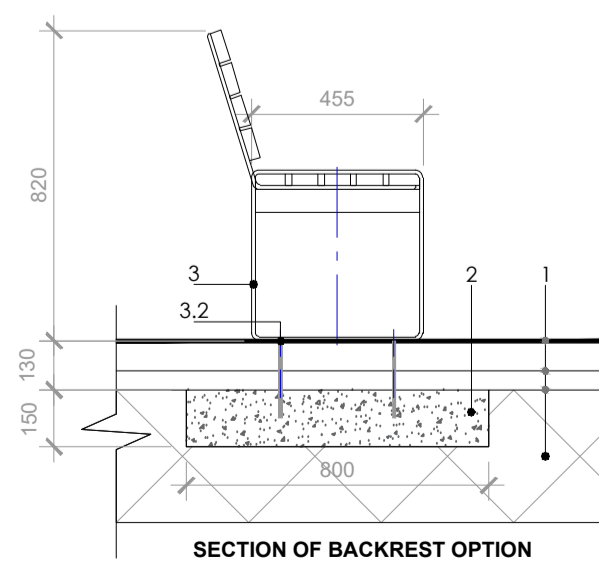
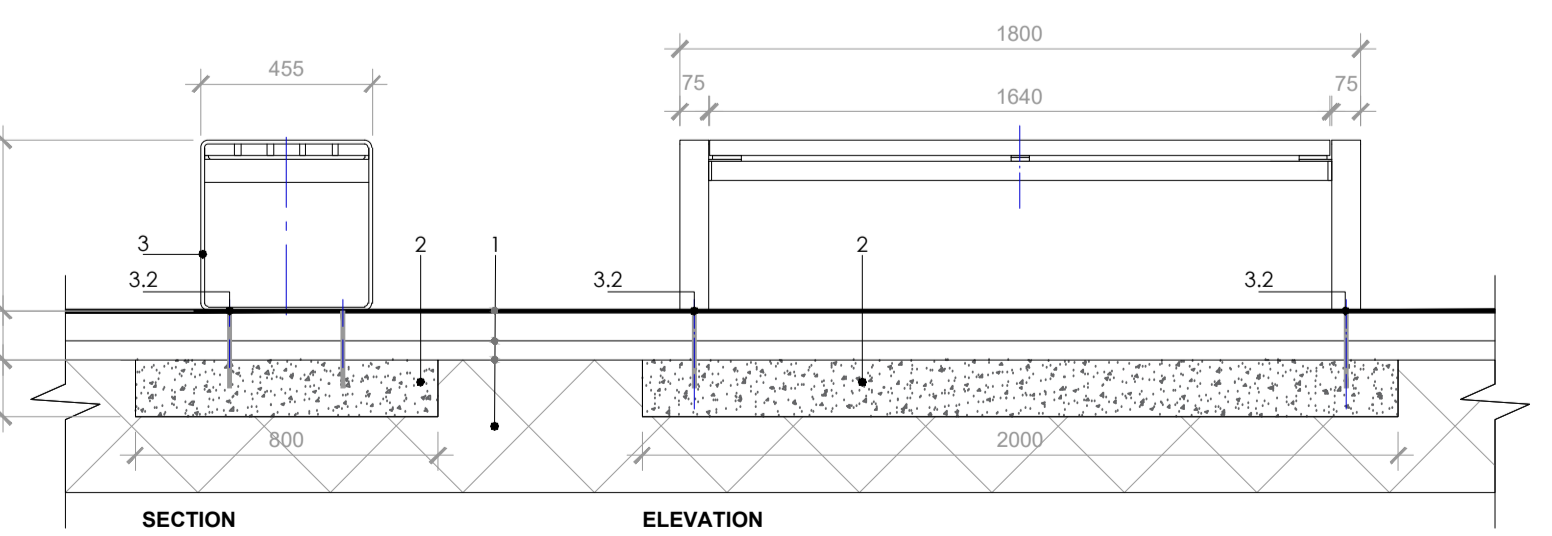
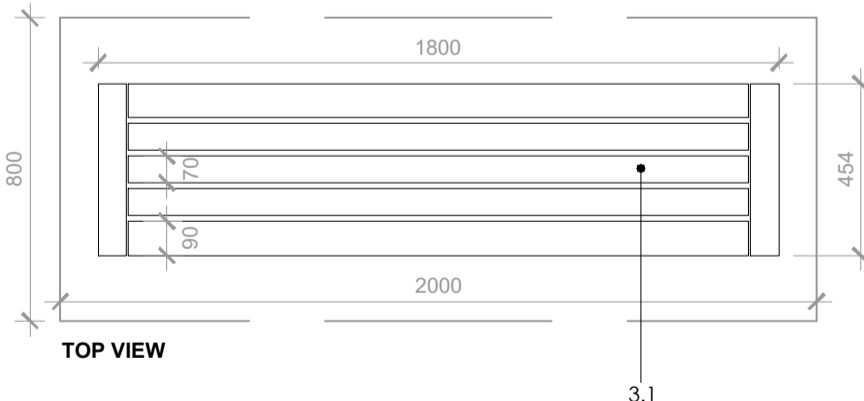

KeyPlan_Scale 1:2000

- This drawing is intended to show landscape architectural proposals only. Please refer to Architects and Engineer's drawings for relevant details of buildings, structures, roads, parking, etc.
- The copyright of this drawing is vested with Murray & Associates. This drawing may not be copied or reproduced without written consent.
- All materials related to on the drawing, including plant species, are indicative and subject to change following detailed site investigation. Significant changes, if any are required, will be referred to the relevant authority for agreement.
- This drawing is not suitable for use for construction purposes.
- Discrepancies to be referred to Murray & Associates for clarification.

murray & associates
landscape architecture

14 The Sepoynil Building, mail@murrayassociates.com
44-45 Central Road, www.murrayassociates.com
Dubai-3, D03 9F63 +933 (0)11 854 0090

REV	DATE	REVISION	DRAWN	CHECKED
0	16/03/22	IFP	HT	MB

CLIENT
Lismore Homes Ltd.

PROJECT TITLE
GA2 Baldoyle

SHEET TITLE
Landscape Details Sheet 3 of 4

SHEET NO.	SHEET SIZE
1819_PL_D_03_IFP	A1
SCALE	REVISION
As Shown	0
STAGE	DATE
Planning	16/03/22